

PLAN VIEW

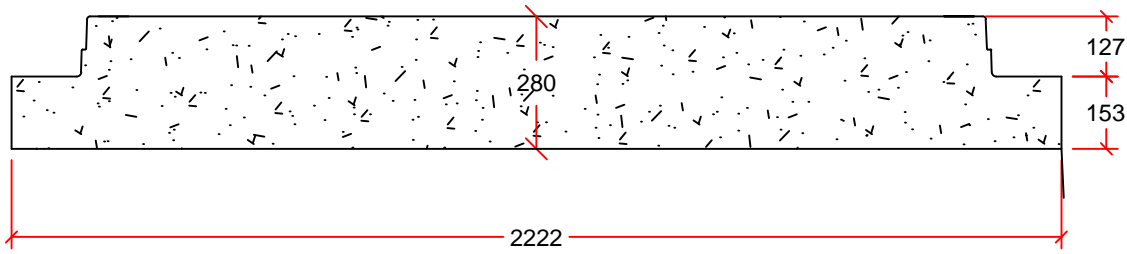

PROFILE VIEW

DRAWN BY:	KIM PHAM	1800mm MANHOLE BASE	<p>INLAND Pipe</p> <p>7336 112th AVE NW, CALGARY, AB. PH: 403-2795531 FAX: 403-279-7648</p>
SCALE:	NTS		
DATE:	NOVEMBER 25, 2015	DIMENSIONS IN mm	
DRAWING #:	1800mm MH BASE	APPROX MASS: 2405 kg	
REVISION #:	REV. 1		
CHECKED BY:	TYSON DYCK		